

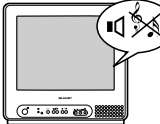

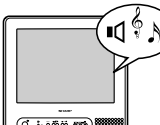

Troubleshooting

If the TV does not react to the Remote Control or the front buttons, please switch OFF at the main switch for a few seconds and back On, then try again.

PROBLEM	CHECK ITEM	PAGE
 <p>No picture or sound</p>	- TV not plugged in Outlet Power OFF	6
	- Main Power button of TV not ON	5
	- Aerial not connected to terminal at the back of the TV set	5
 <p>Sound OK, poor picture</p>	- Increase the volume.	15
	- Aerial not connected to terminal at the back of the TV set	5
 <p>Picture OK, poor sound</p>	- Adjust CONTRAST, COLOUR and BRIGHTNESS controls	16
	- Increase the volume	15
 <p>Picture weak/No colour</p>	- Increase the volume	15
	- Aerial not connected to terminal at the back of the TV set	5
	- Adjust COLOUR control	16
 <p>Poor reception on same channels</p>	- Try fine tuning to correct	10
	- Aerial not connected to terminal at the back of the TV set	5
 <p>Remote control does not work</p>	- Check for local interference	5
	- TV not plugged in Outlet power OFF	6
	- Main Power button of TV not ON	6
	- Turn OFF using the Main Power button, then turn On again after a minute	6
	- Check batteries in the Remote control	4

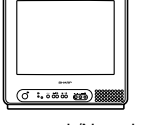
Part names

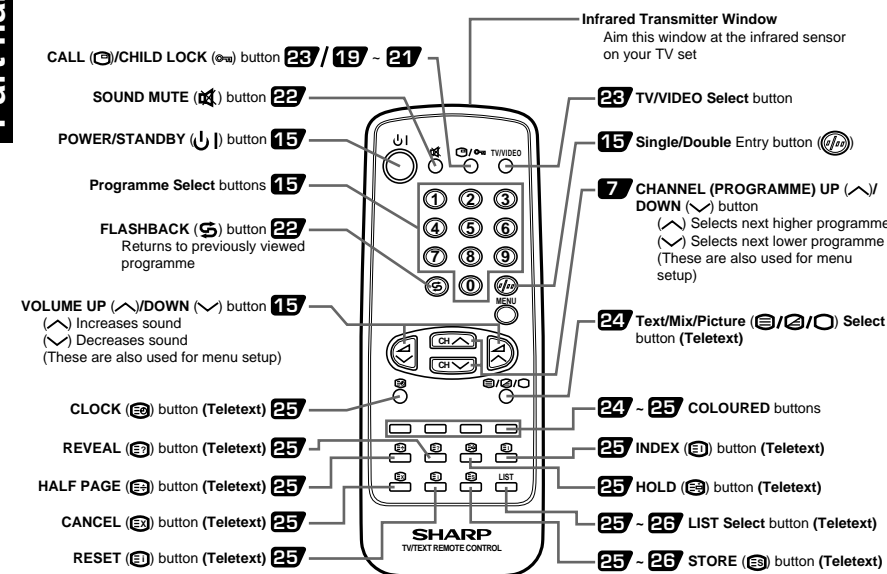

SHARP ELECTRONICA ESPAÑA, S.A.

SHARP ELECTRONICS (U.K.) LTD.
Sharp House, Thorp Road, Newton Health,
Manchester M40 5BE

 PRINTED ON ENVIRONMENTALLY FRIENDLY PAPER

PRINTED IN SPAIN
TINS-7243BMN0
09/02

Quick Start Guide

15JF-26H

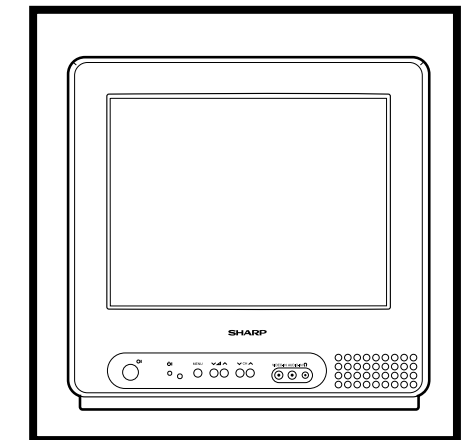

Installation

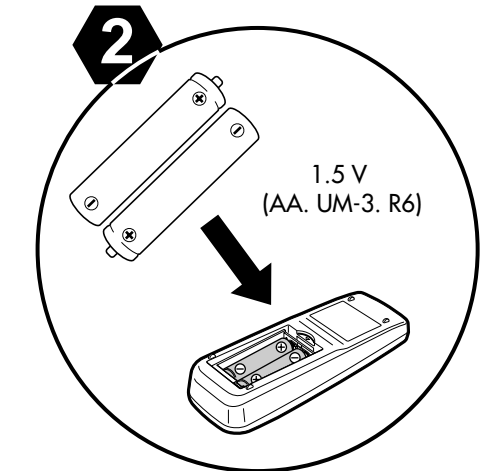
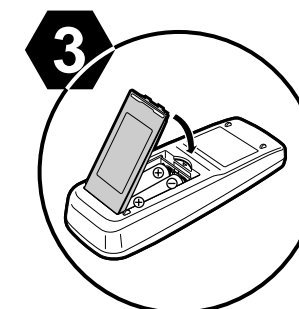
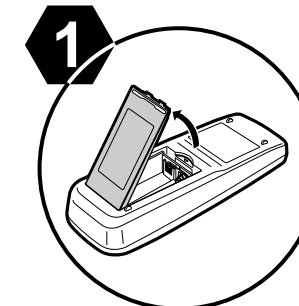

Insert two (AA or UM-3, 1.5 V) batteries into the remote control. Position the positive and negative ends of the batteries as indicated.

If problems persist contact the SHARP Help line (office hours) on tel:08705-274277 [or (01)676 06 48 if telephoning from Ireland] and/ or WEB-SITE: www.sharp.co.uk/support

4 Connect the Aerial Lead to the TV set.

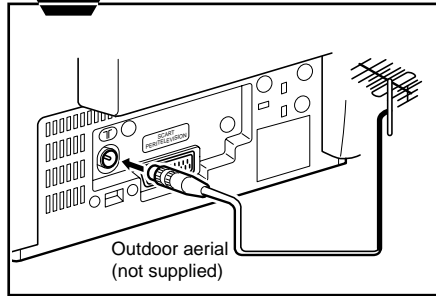

5 Plug in your TV into the mains supply.

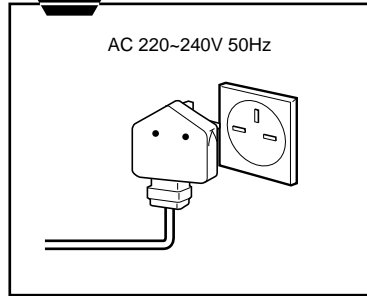

Typical connection (VCR and TV) through the RF terminal.

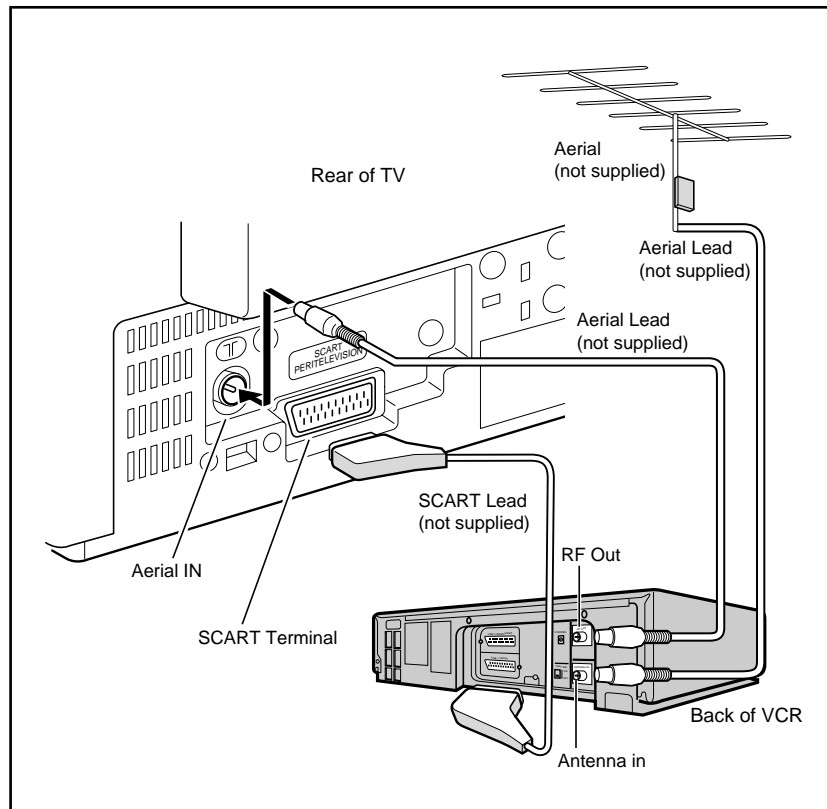

4 Press the MENU button on the TV or remote control to start the AUTO TUNING. The tuning process may take several minutes.

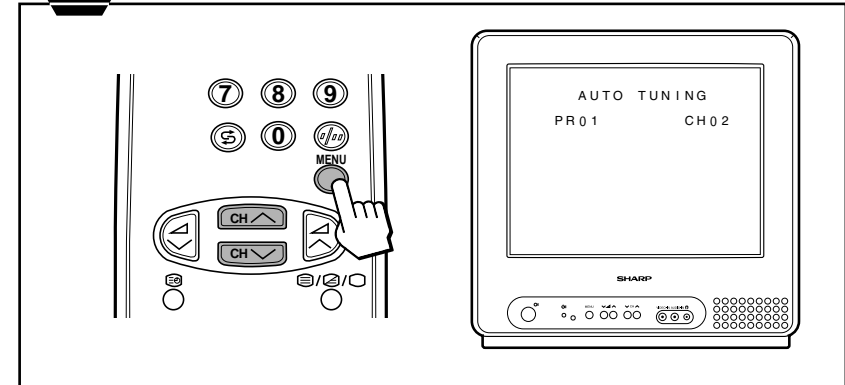

1 Press the main POWER(OI) button on the TV. The POWER indicator lights up in red.

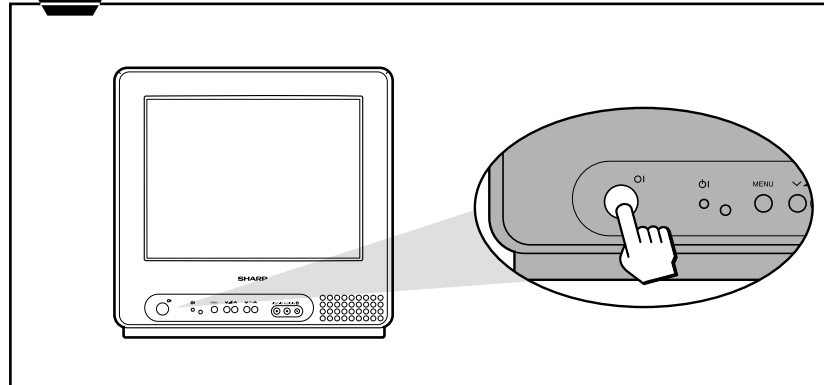

2 The AUTO TUNING message will appear on your TV screen. Follow the instructions on the TV screen.

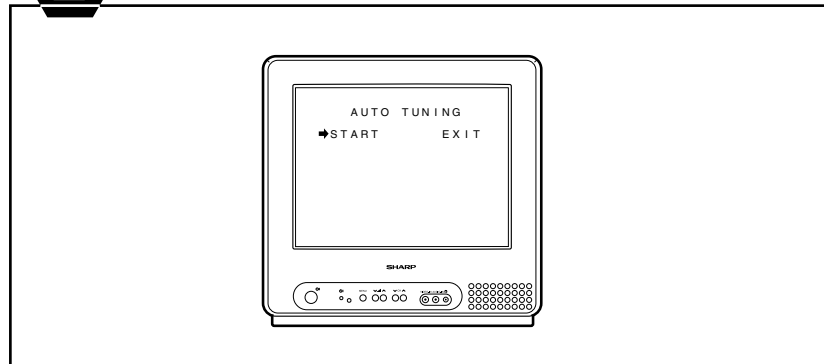

3 The AUTO TUNING function will tune all available TV stations into your TV. If you do not intend to use your TV with a VCR then please proceed to step 4.
If the TV is being used with a VCR, turn on the VCR and play back a prerecorded tape. If you have a SCART Lead, do not fit at this time.

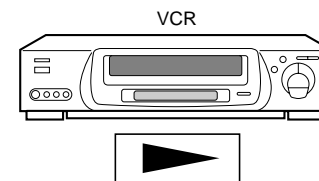

5 After searching has finished the channels will be sorted in the following order (for example).

Prog.	Channel
1	CH21
2	CH31
3	CH41
4	CH51

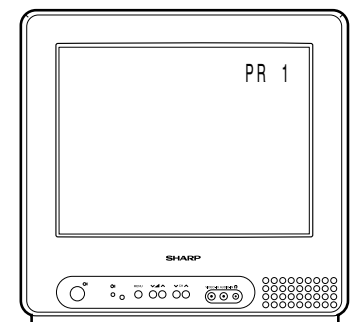

If you wish to change the order, refer to the relevant section on page 13 of the operation manual.
If you need to repeat "AUTO TUNING", refer to the relevant section on page 7 of the operation manual.